

Little Anne

Stop Rope Installation Guide

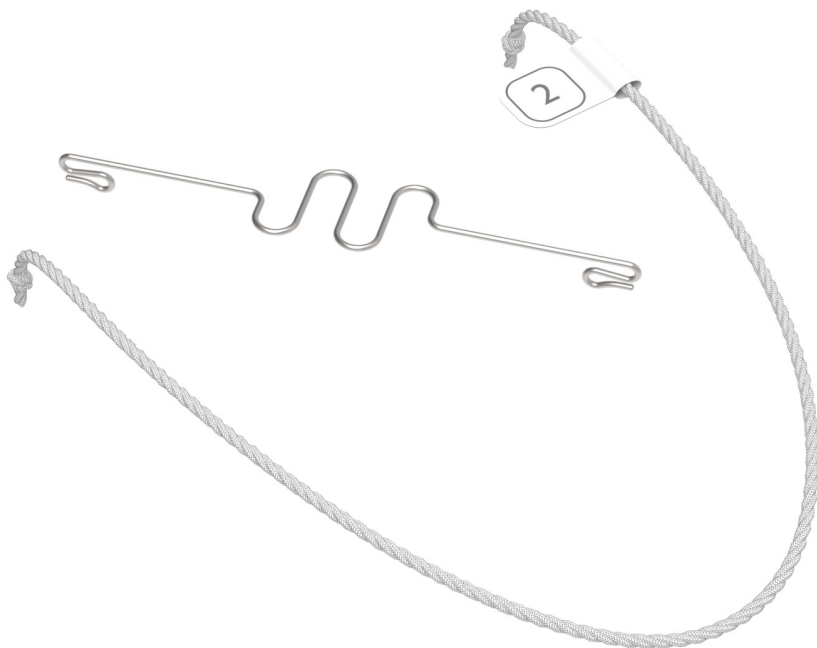

Watch our video with more detailed instructions.



laerdal.com/support/how-to-videos/little-anne-videos/

For manikins with the older chest plate string, please cut as shown below before starting the installation.

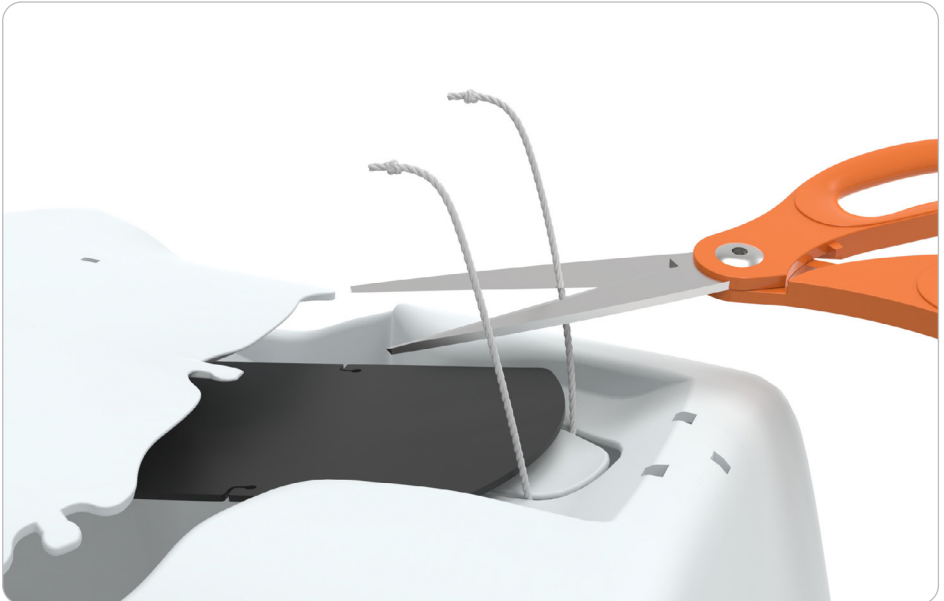

Installation

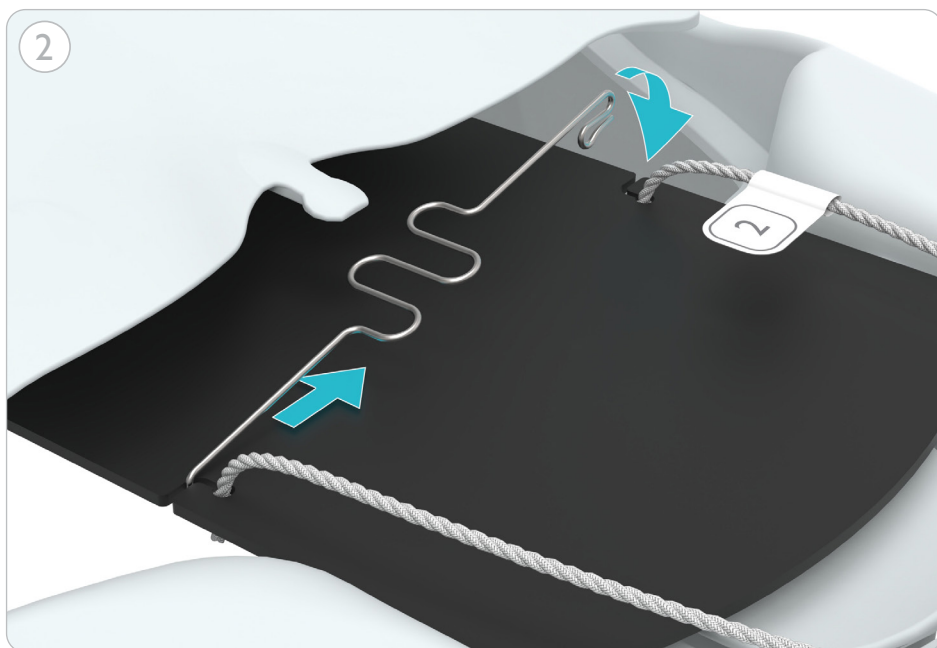
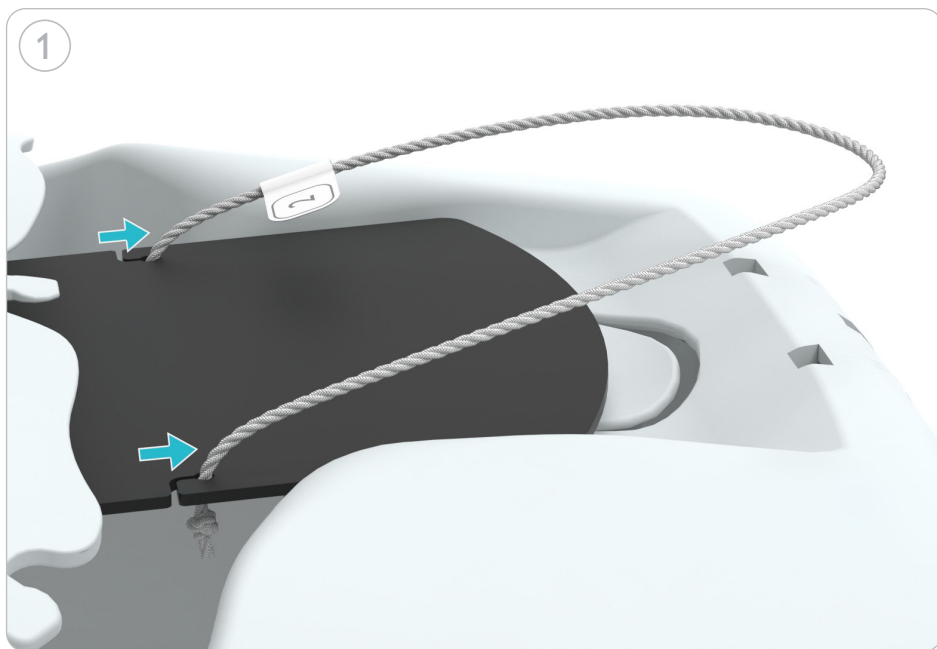

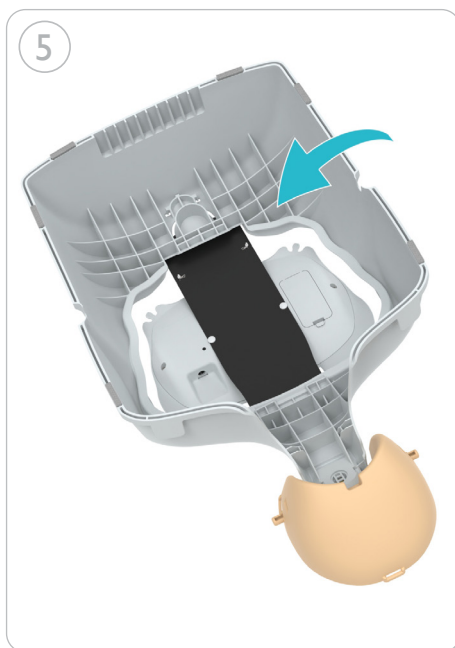
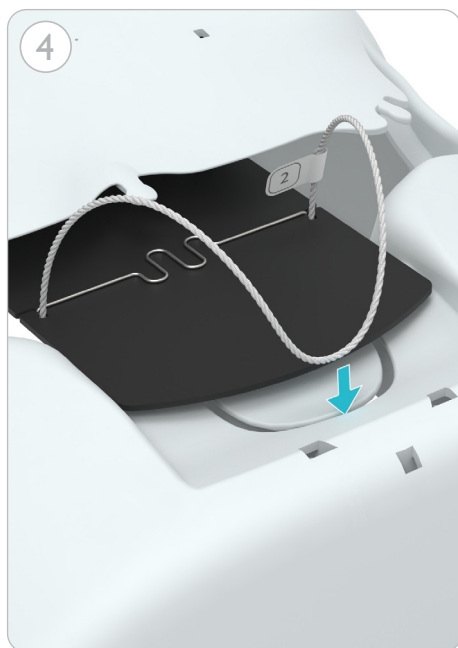
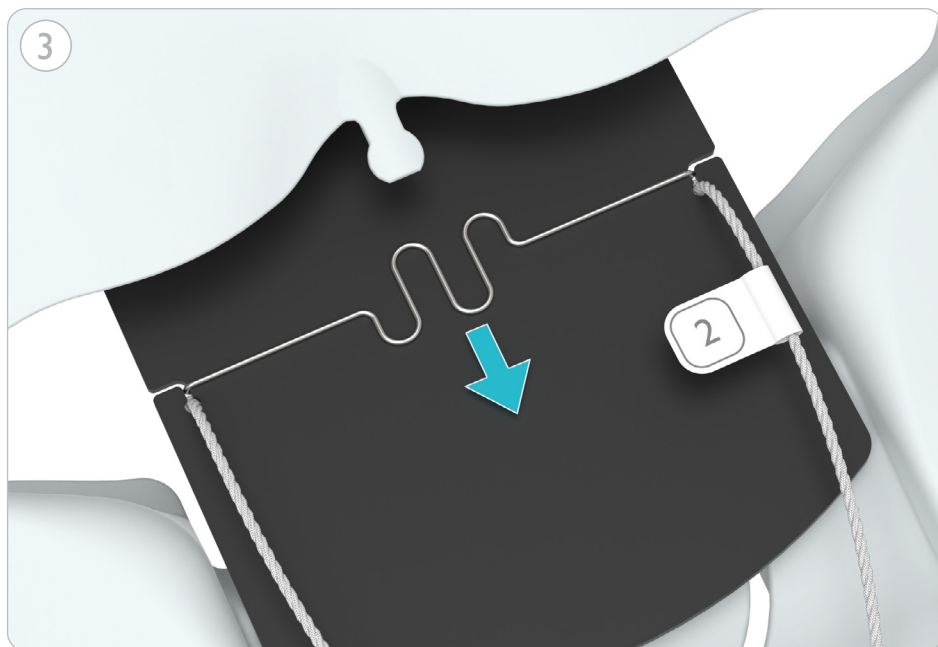

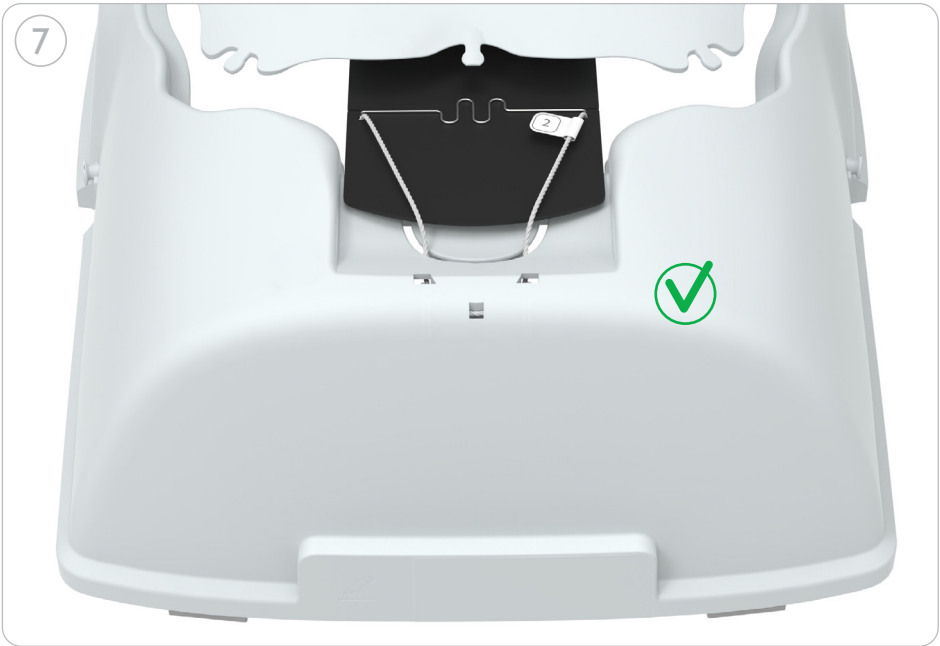
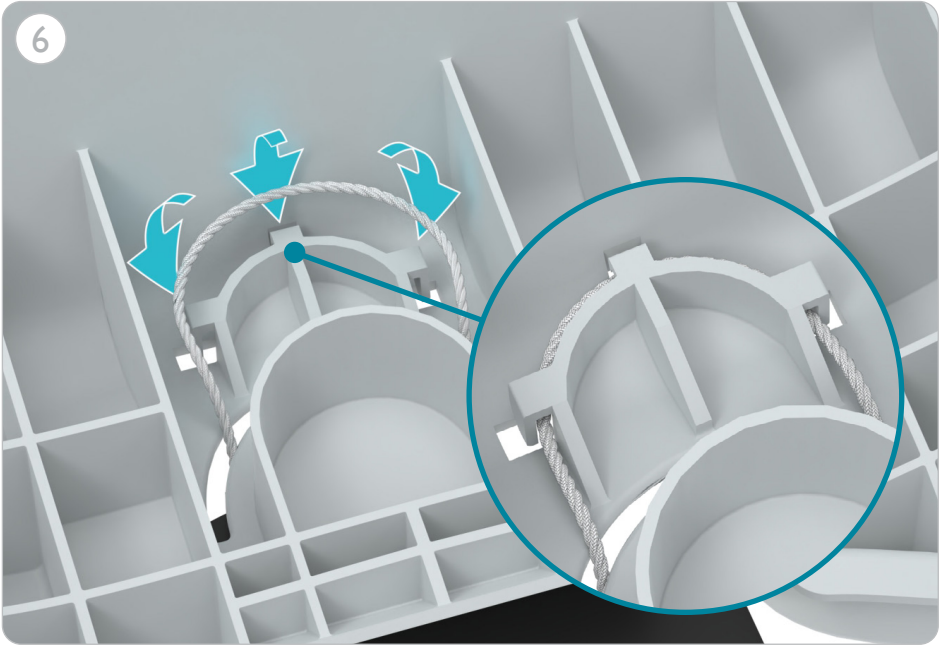

© 2025 Laerdal Medical AS. All rights reserved.



Manufacturer: Laerdal Medical AS
P.O. Box 377
Tanke Svilandsgate 30, 4002 Stavanger, Norway
T: (+47) 51 51 17 00

20-23204 Rev B

www.laerdal.com



Laerdal
helping save lives