

ShockLink

User Guide

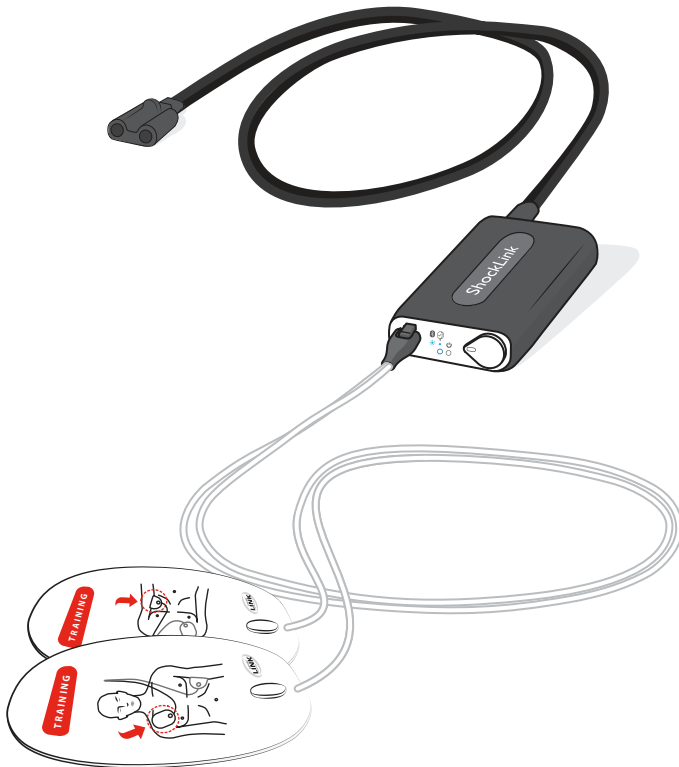

Intended Use

ShockLink enables the connection of compatible live defibrillators to ShockLink prepared training manikins and Patient Simulators, creating more realistic Basic Life Support (BLS) and Advanced Cardiac Life Support (ACLS) defibrillation training.

Connect ShockLink to training pads and a compatible defibrillator to begin training. The shock energy from a defibrillator is defused in the ShockLink cable.

ShockLink removes the need for specialised defibrillator training manikins and Patient Simulators with chest-studs or a load box to absorb the shock.

Visit www.laerdal.com/ShockLink for more information about ShockLink, ShockLink Technology and for Spare Parts and Accessories.



ShockLink



Remote Control ShockLink



1 x AAA battery



Training Pads



Pouch

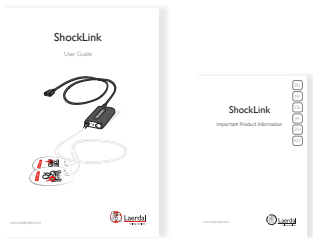

User Guide Important Product Information



Overview - ShockLink

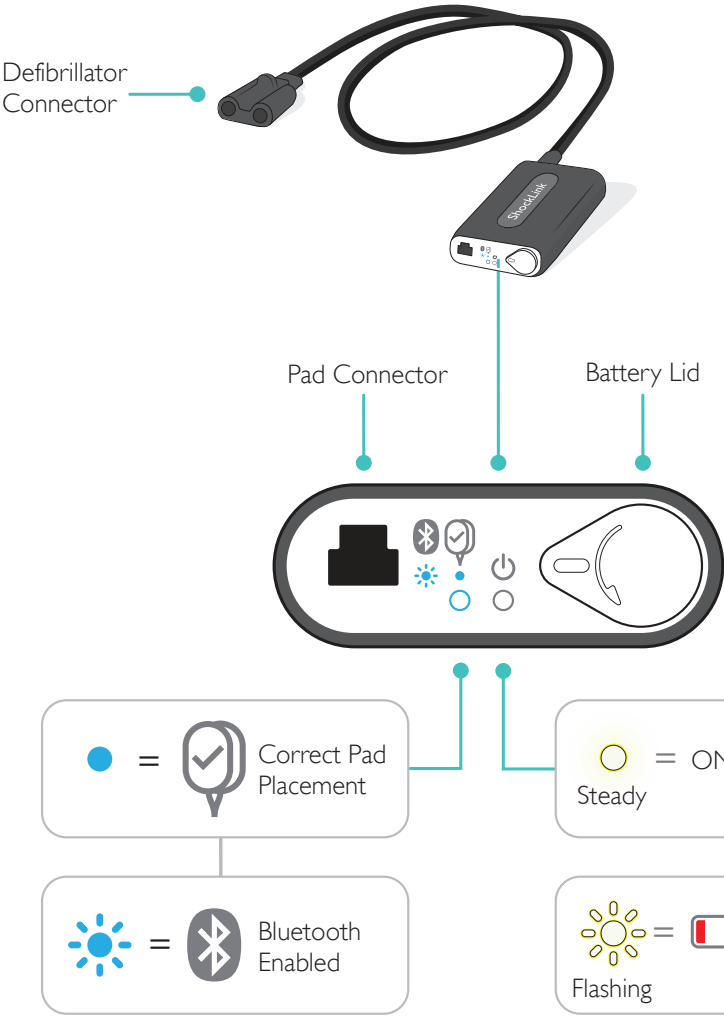

Note

For more information regarding compatibility with defibrillators other than a Philips defibrillator, visit www.laerdal.com/ShockLink.

Overview - Remote Control

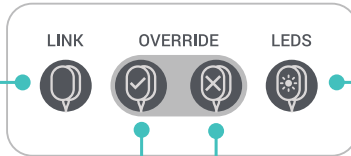

Pads Placement Indication

Override Pad Placement: Pads ON

Override Pad Placement: Pads OFF

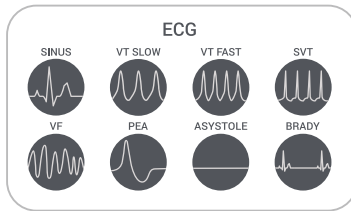

Select ECG

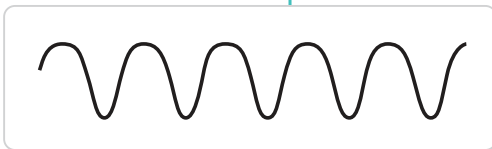
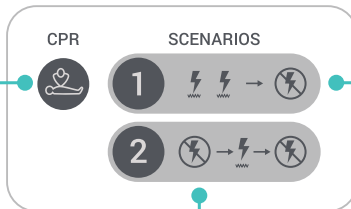

CPR Artefact

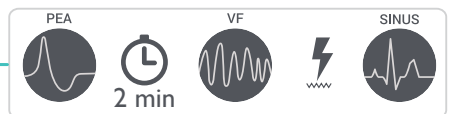

Note

Laerdal LINK Technology detects correct pad placement automatically.

Setup

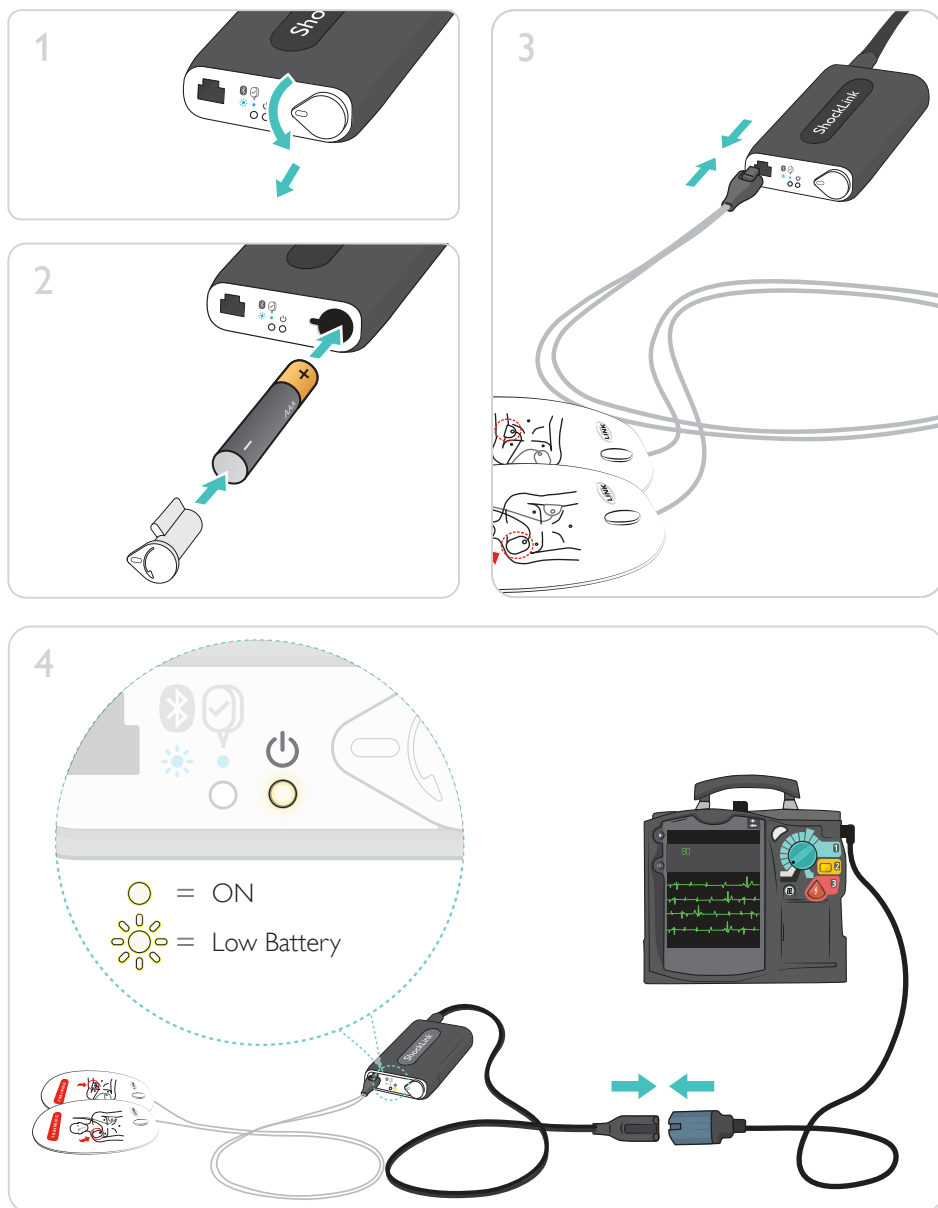

Note

ShockLink is automatically turned on when the defibrillator is turned on.

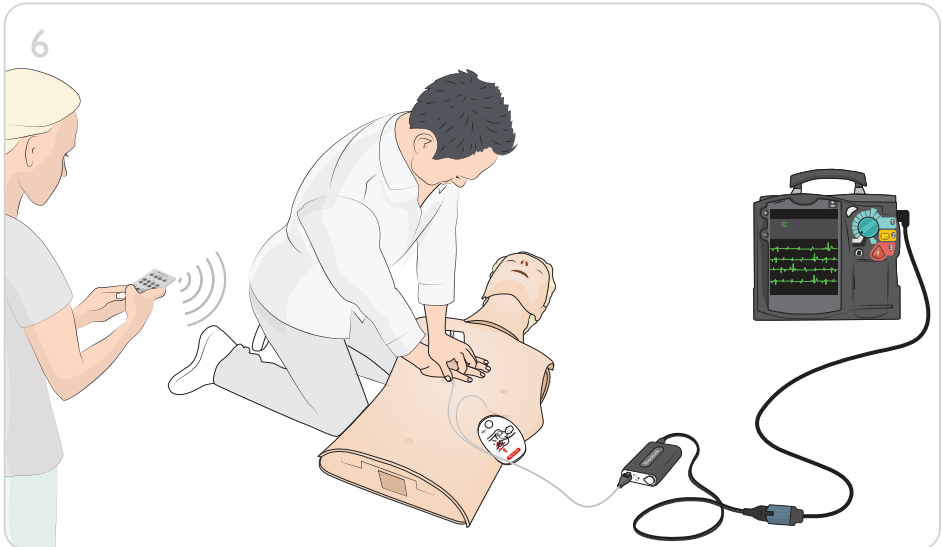
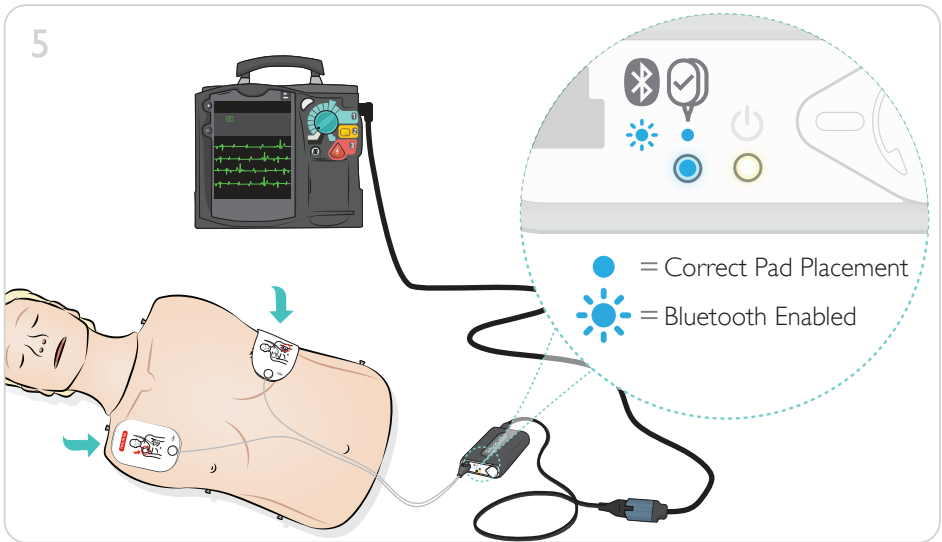

Notes

- To reset the ShockLink device, remove the battery and reinsert after 5 seconds.
- Remove training pads immediately after use to prevent adhesive residue on the manikin chest skin.

Setup - Compatibility

Select one of the following control options:

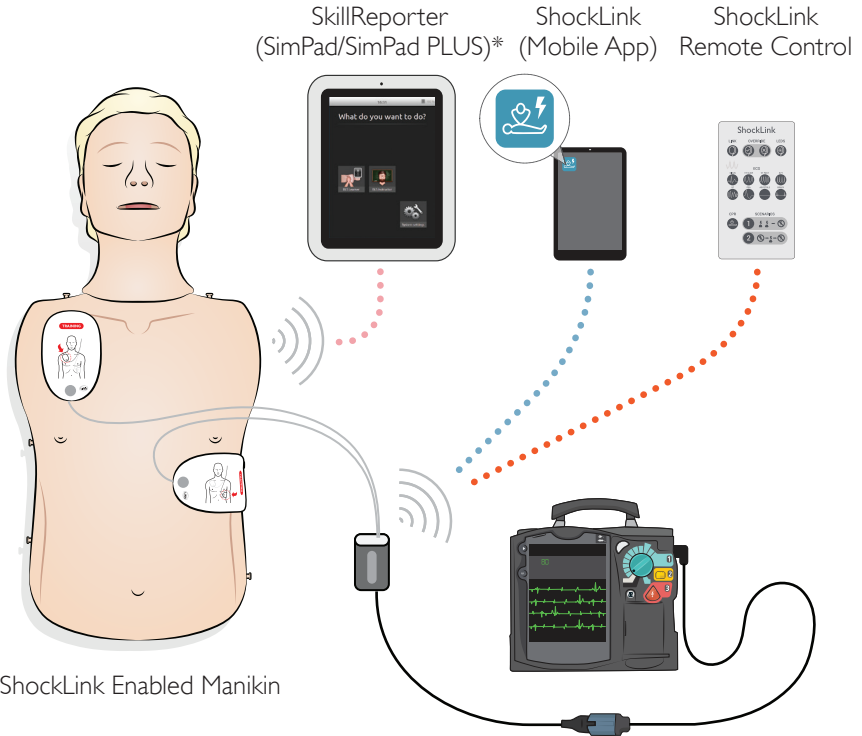

- WiFi
- Bluetooth
- Infra Red

* SkillReporter communicates with ShockLink via the manikin after correct pad placement has been detected.

** Visit www.laerdal.com/ShockLink for compatible Manikins and Simulators.

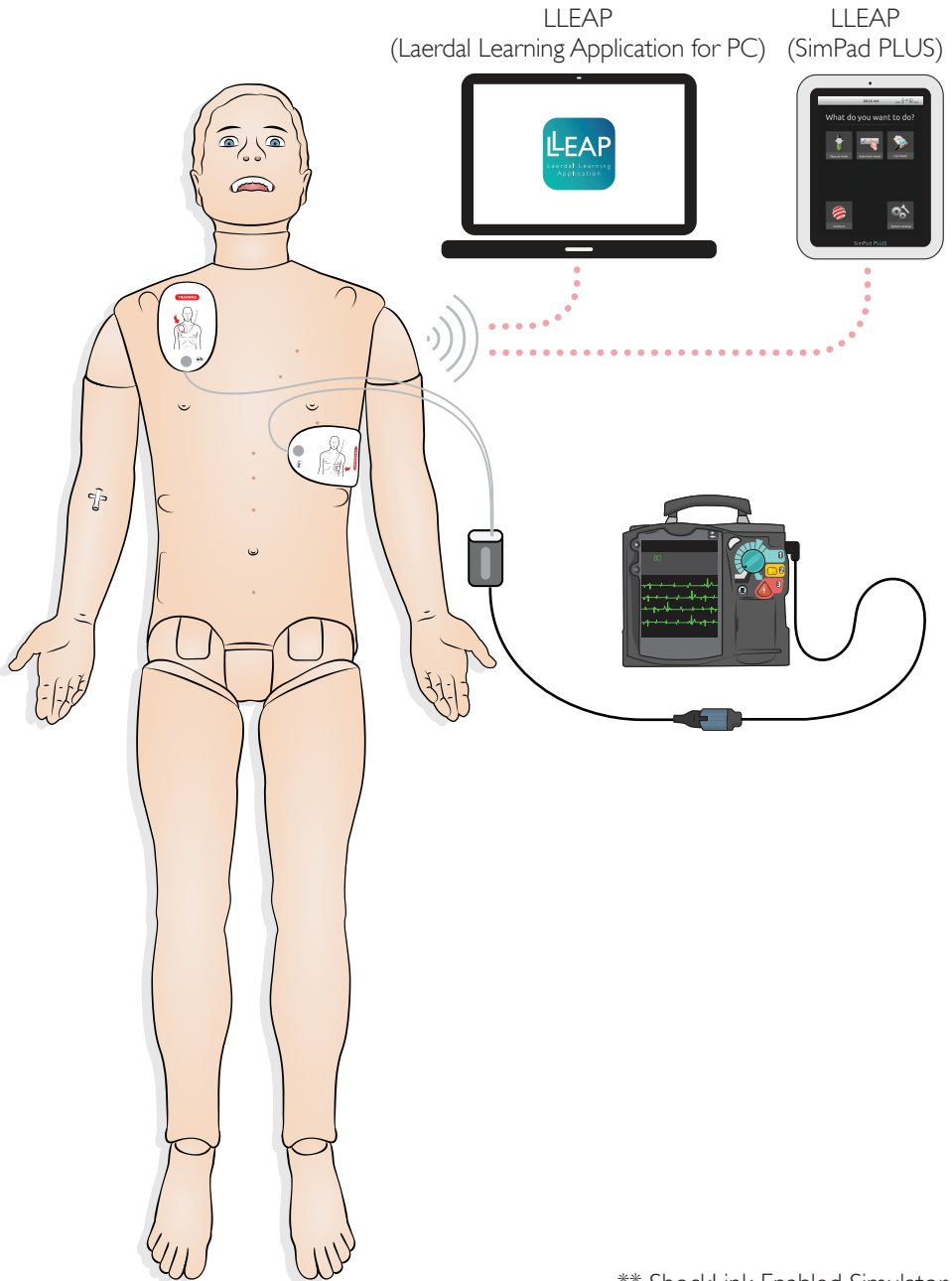

** ShockLink Enabled Simulator

ShockLink® Patent Pending
Laerdal Medical, the Laerdal logo and ShockLink are
trademarks owned by Laerdal Medical AS.

© 2025 Laerdal Medical AS. All rights reserved.



Laerdal Medical AS
P.O. Box 377
Tanke Svilandsgate 30, 4002 Stavanger, Norway
T: (+47) 51 51 17 00

Manufactured by
Eastek International (Malaysia) Sdn. Bhd.
65 Barrage Industrial Estate, Mergong,
05150 Alor Setar, Kedah, Malaysia

20-09355 Rev C

