

SimMom

Automatic Delivery Module Upgrade Kit Setup Guide

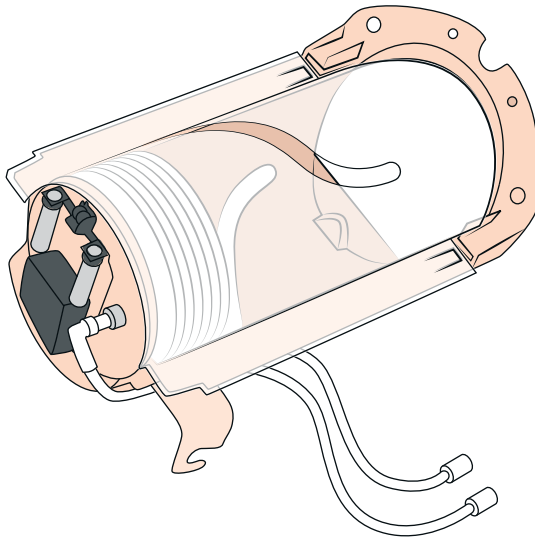

ITEMS INCLUDED

A

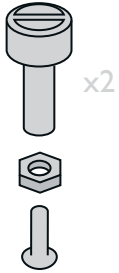

B



C



D

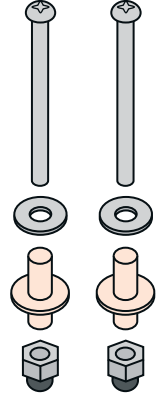

E

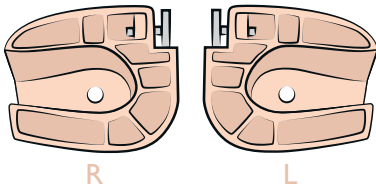

F



G

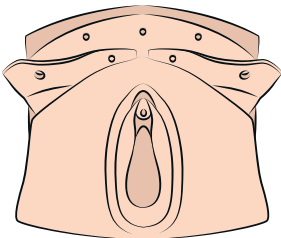

H

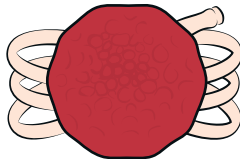

I

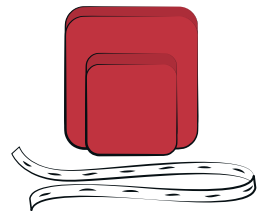

Please follow all the steps to the upgrade carefully. Otherwise, problems may occur with performance of the simulator and warranty may be void.

Detach the legs from the torso before starting the upgrade. Use this Upgrade Kit and the tools included with SimMom to perform the upgrade.

Please note that the Automatic Delivery Module requires LLEAP software to operate.

1

REMOVE THE LEGS

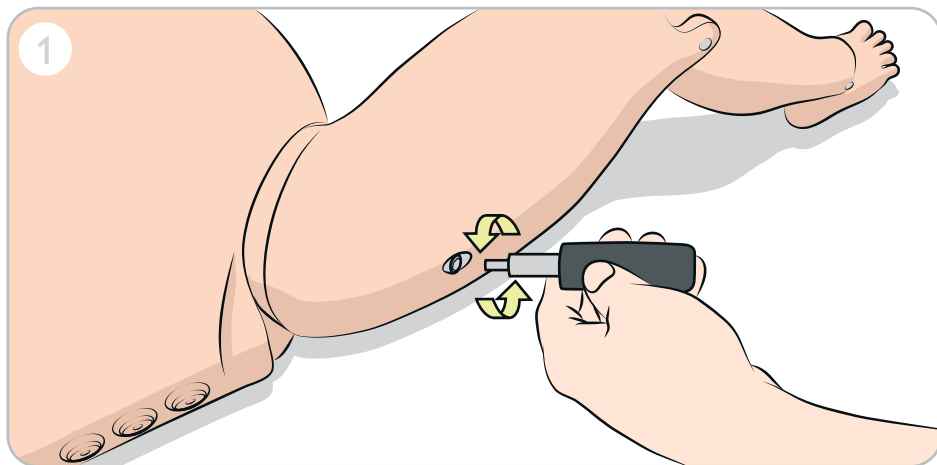

2

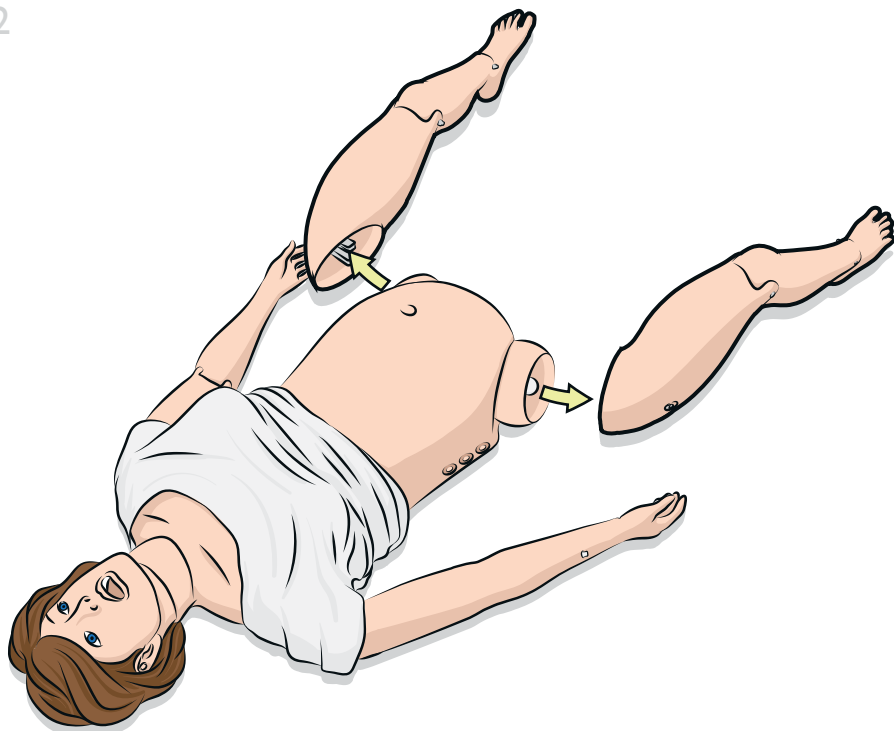

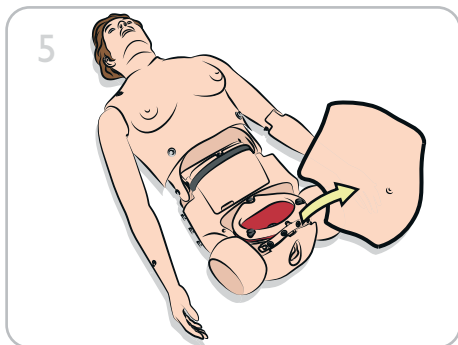
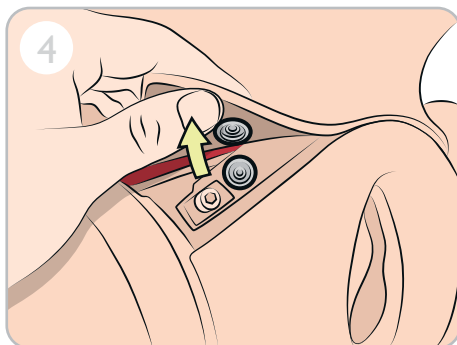
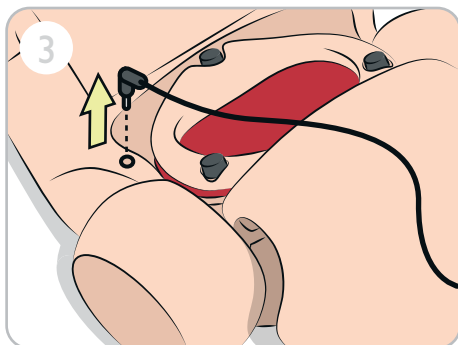
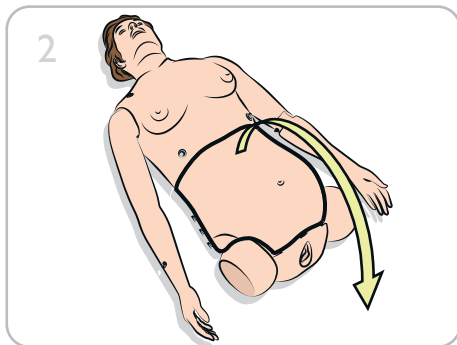
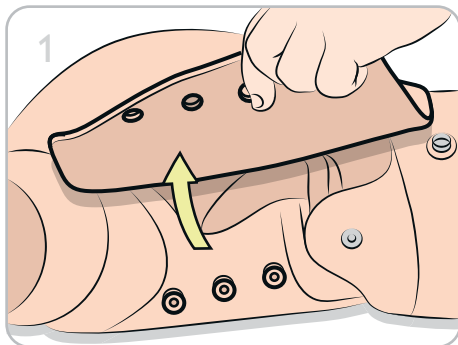

1

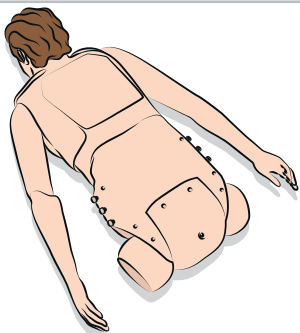

2

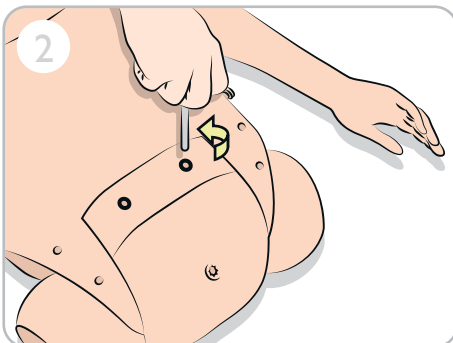

3

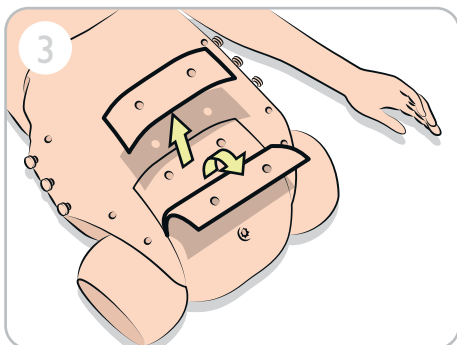

4

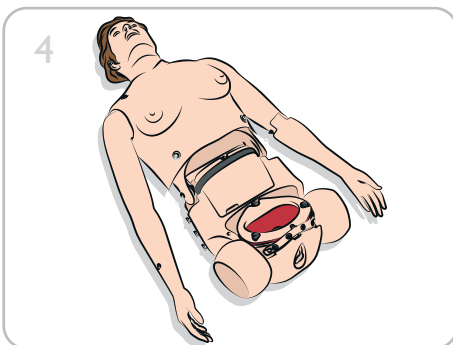

5

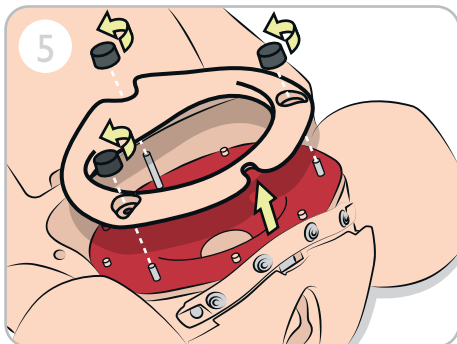

6

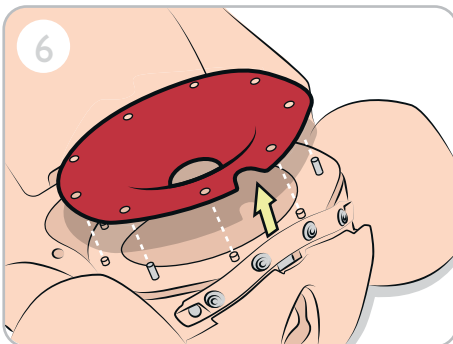

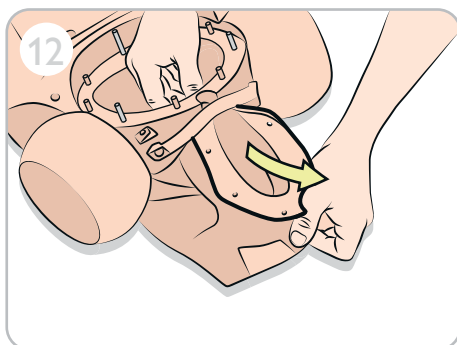
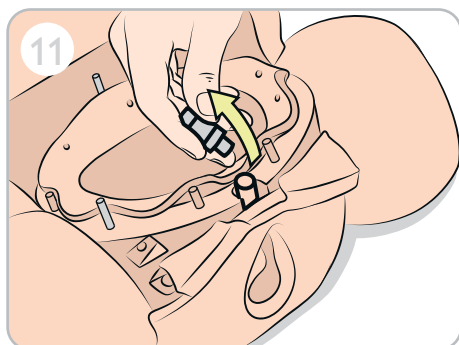
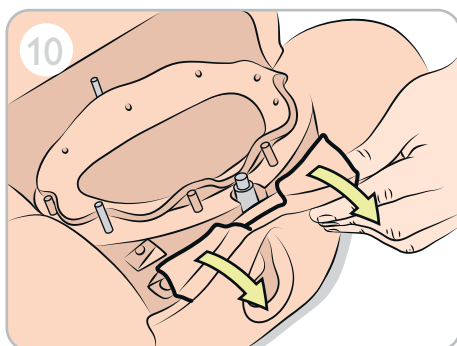
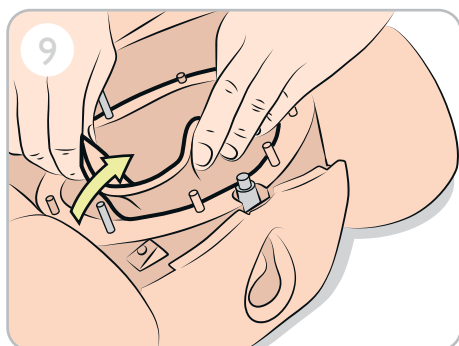
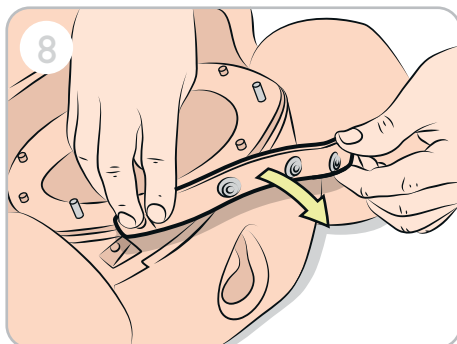
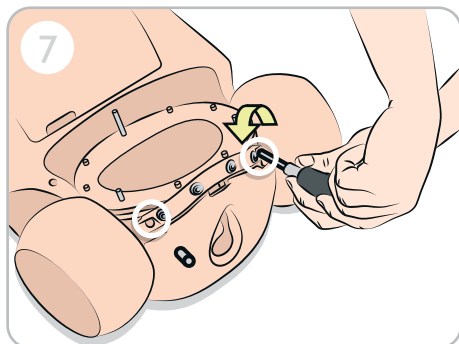

4

CHANGE THE LOWER LONG SCREW

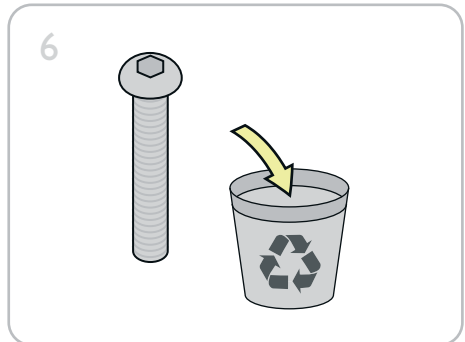
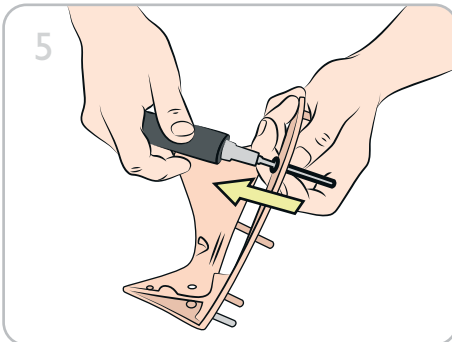
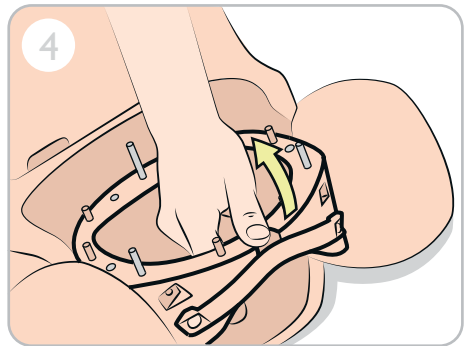
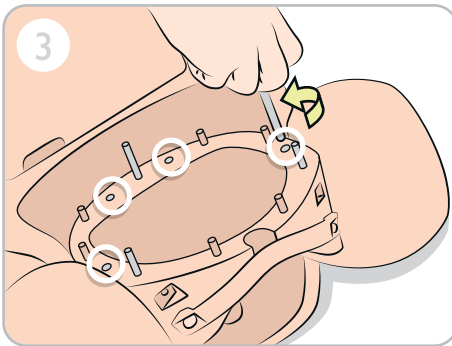
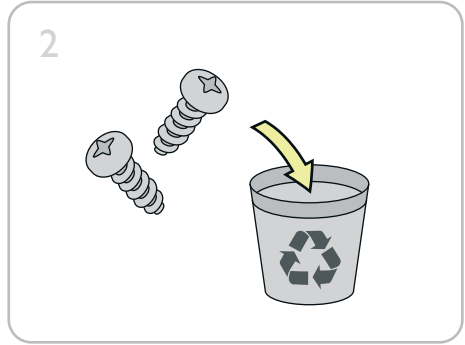
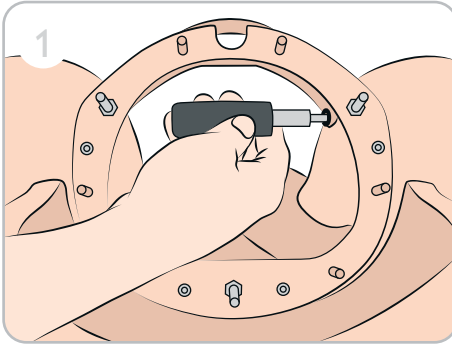

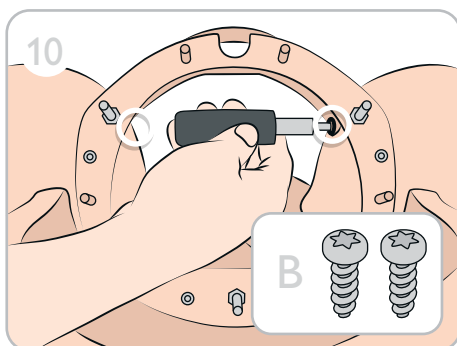
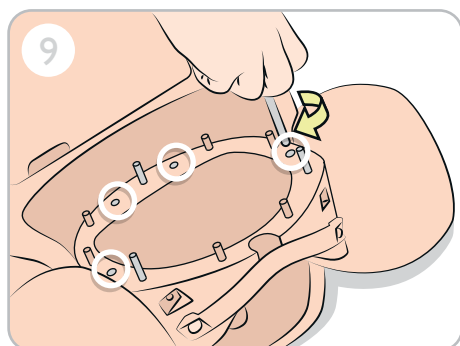
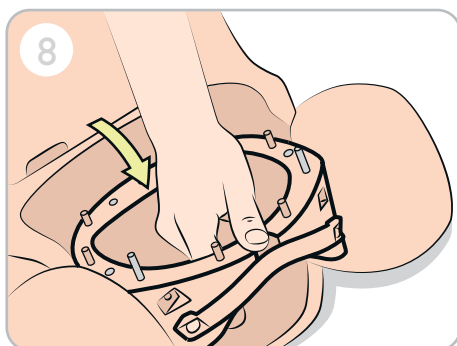
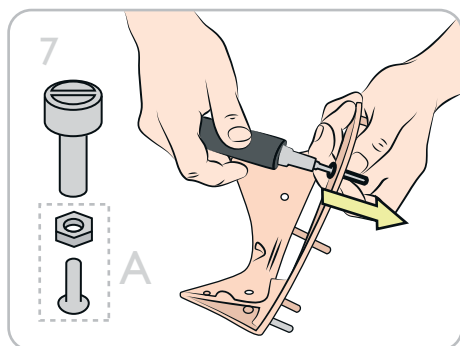

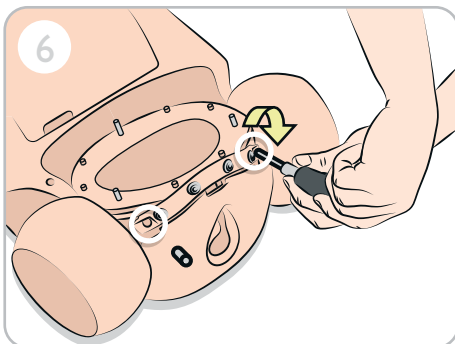
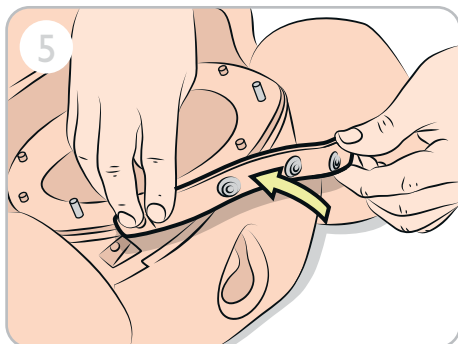
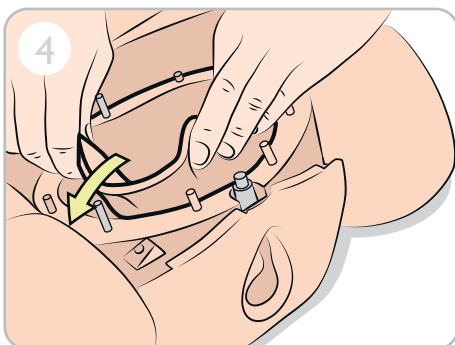
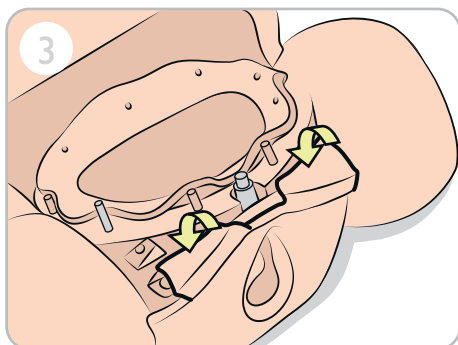
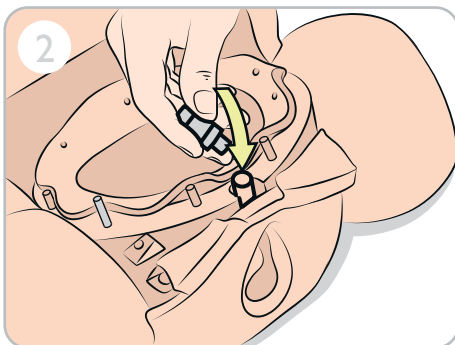
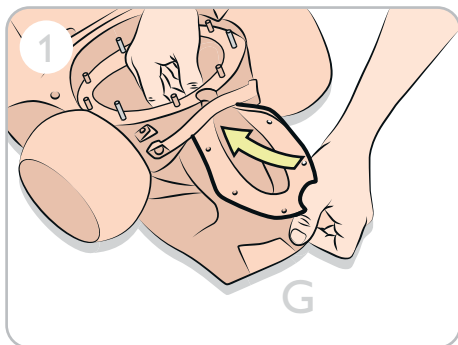

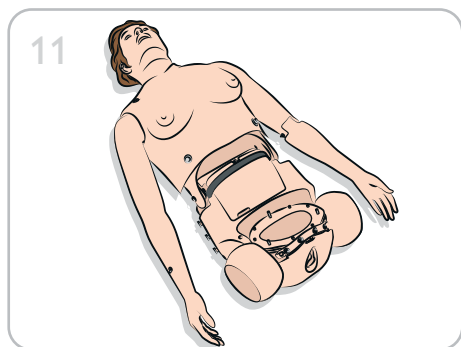
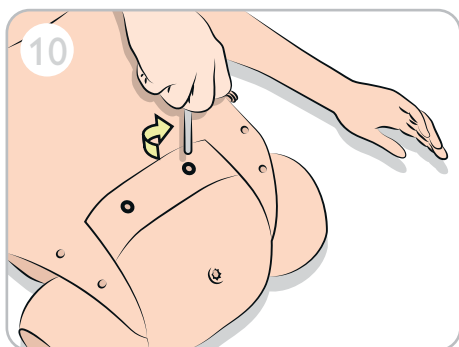
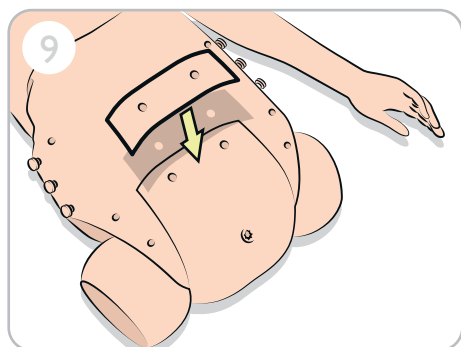
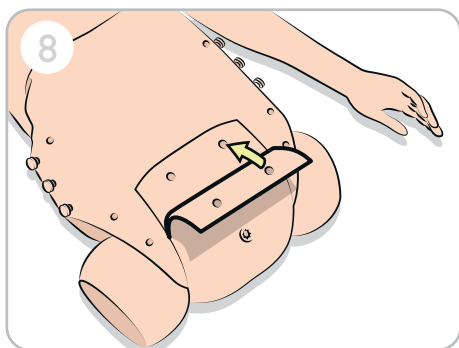
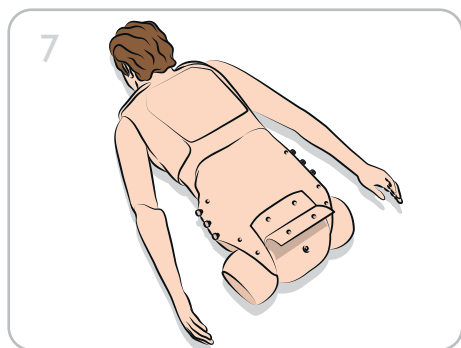

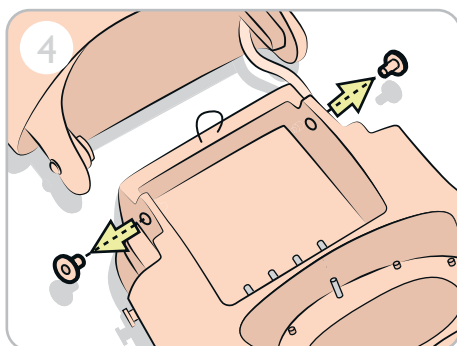
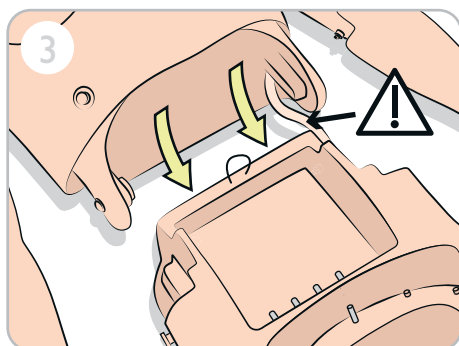
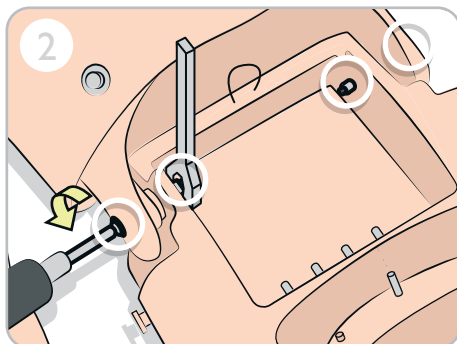
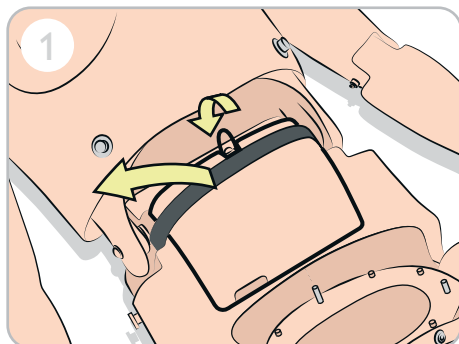

⚠ Be careful to not damage cable.

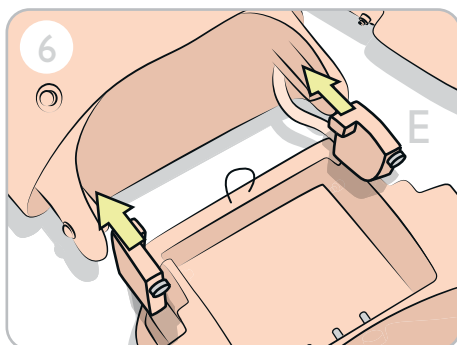
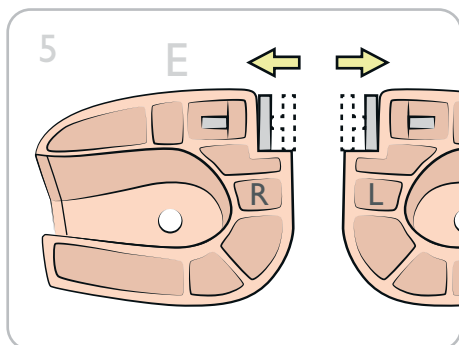

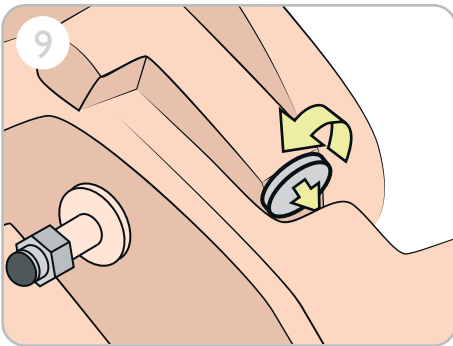
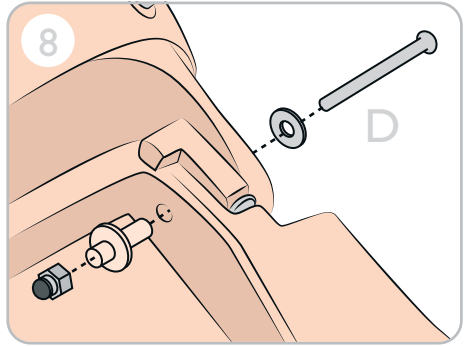
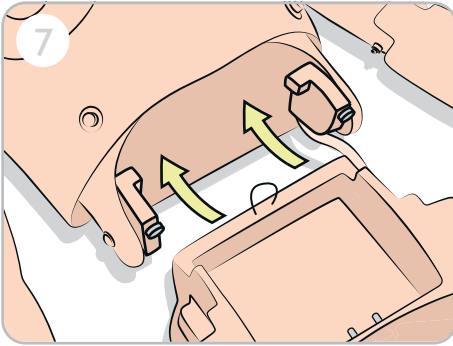

7_A

PREPARE FOR AUTOMATIC DELIVERY

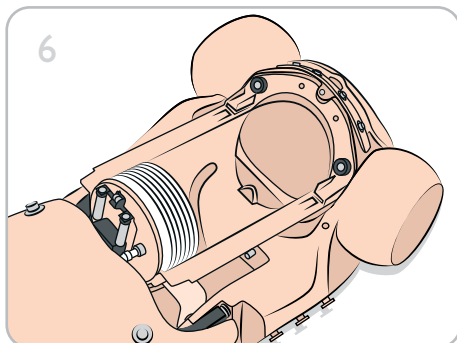
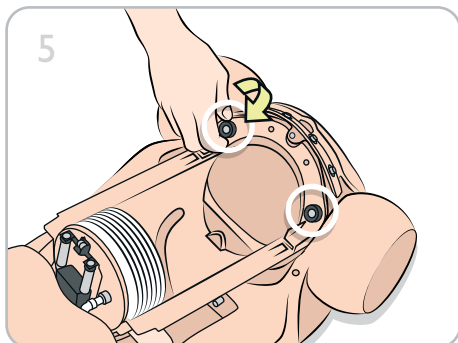
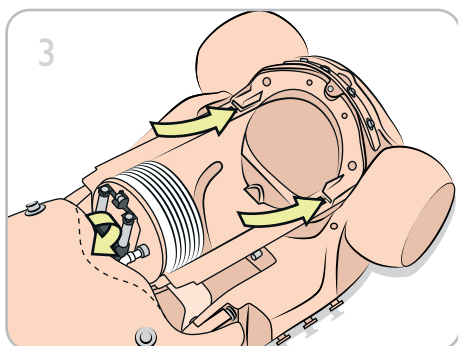
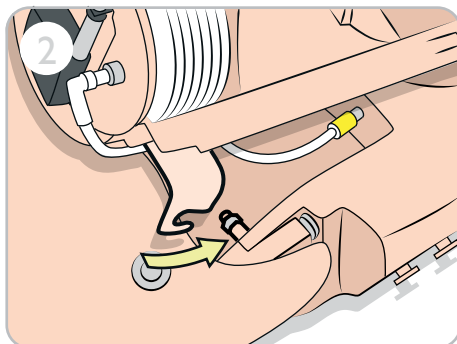
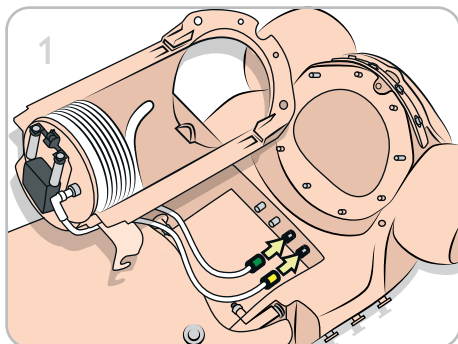

7_B

PREPARE FOR MANUAL DELIVERY

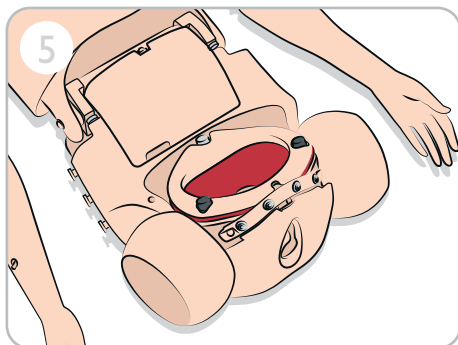
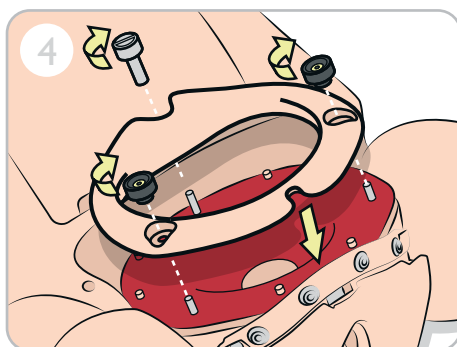
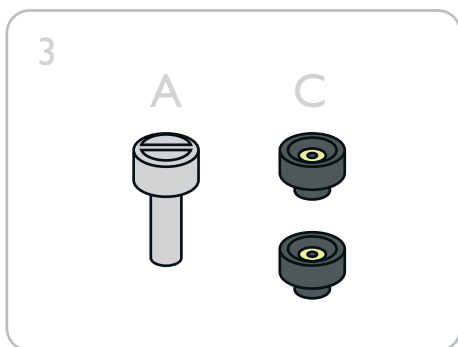
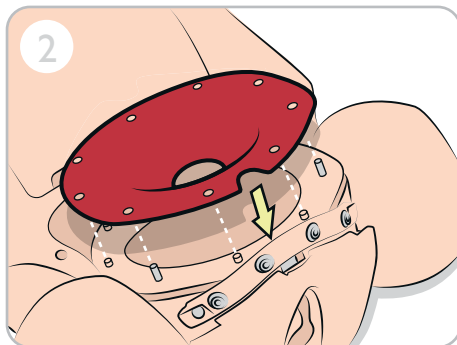
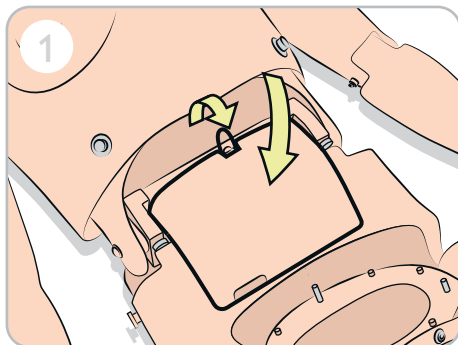

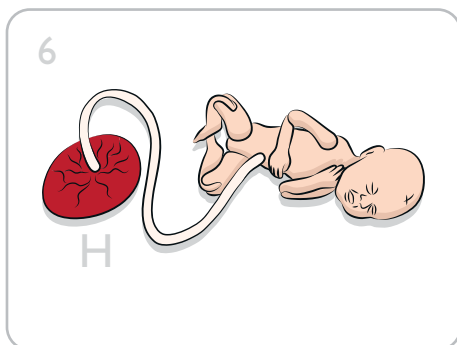
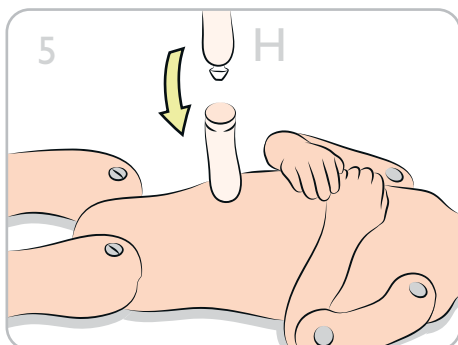
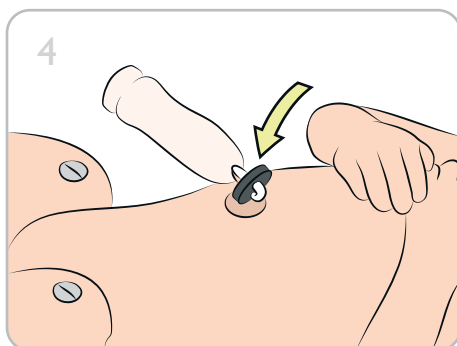
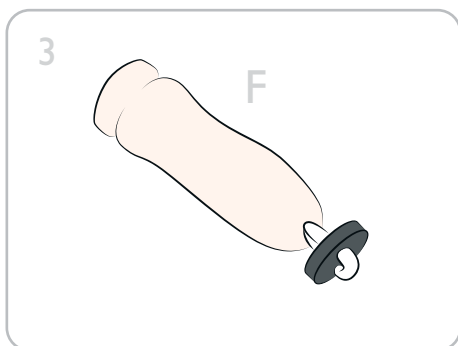
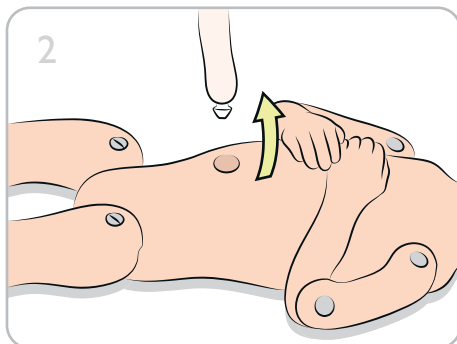
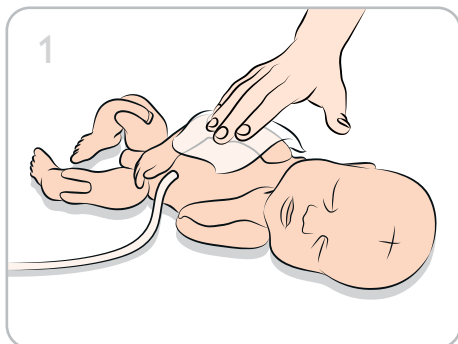

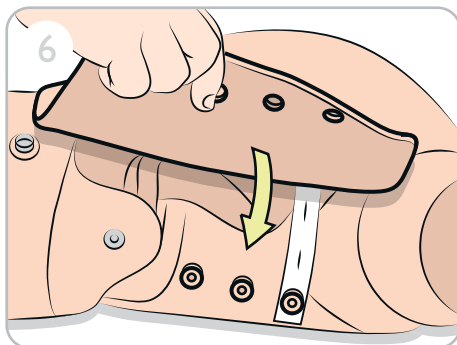
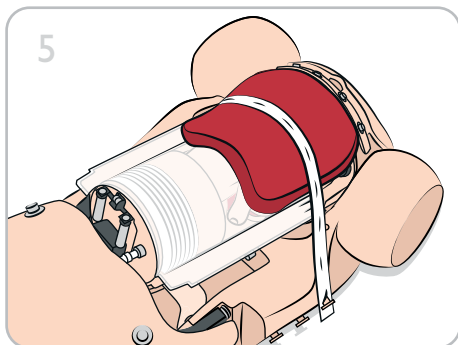
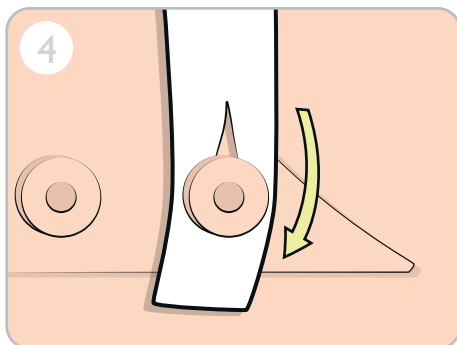
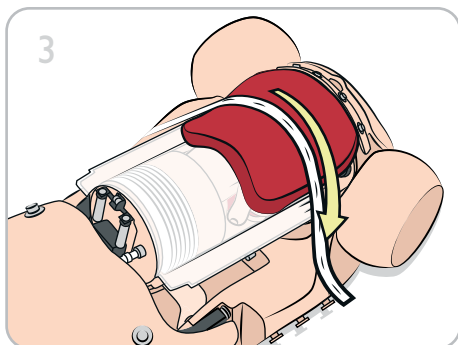
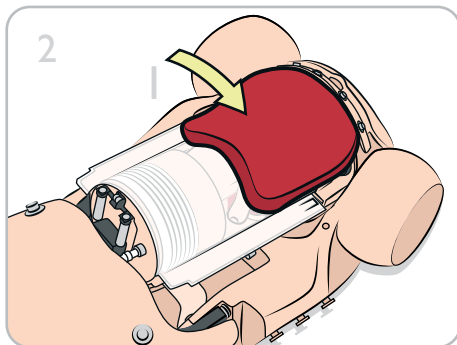
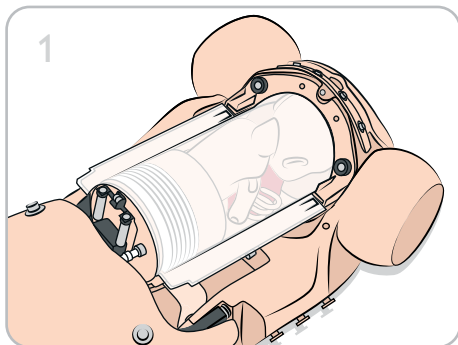

© 2014 Laerdal Medical AS. All rights reserved.
Device Manufacturer: Laerdal Medical AS, P.O. Box 377,
Tanke Svilandsgate 30, 4002 Stavanger, Norway
T: (+47) 5151 1700

Rev A

