

SimBaby

Quick Setup Guide

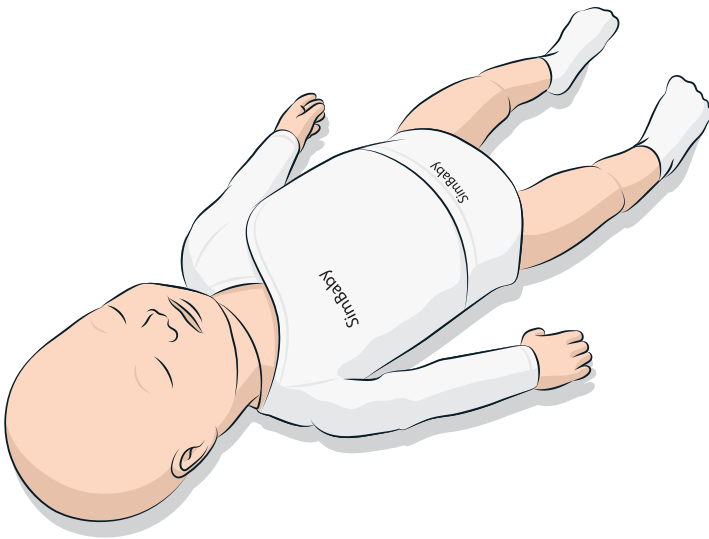

This Quick Setup Guide describes how to assemble and setup your SimBaby patient simulator. For information about how to use SimBaby, please refer to LLEAP help files and SimBaby Directions for Use.

Visit www.laerdal.com/downloads to download the latest Directions for Use and software.



INCLUDED COMPONENTS

SimBaby



Blood Pressure Measuring Kit



Manuals & Warranty

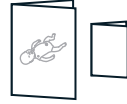

Chest Skin



Pneumothorax Bladder



Eye Set



Lower IV/IO Legs

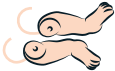

Air and CO2 Tube



IV Blood System

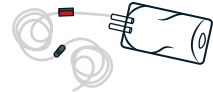

Arm Skin

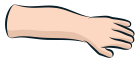

Esophagus Filters x 50



SpO2 Probe



Tubing and IV Clip



Pleura Sleeves x 10



Manual Defibrillation Plates



Link Box



PC and Audio Cable



Simulator Cable



Towel



Lubricant



Baby Powder



Blood Concentrate



REQUIRED

Instructor PC



Compressor



Ethernet Cable for PC



RECOMMENDED

Patient Monitor



Headset



Ethernet Cable for Patient Monitor



1

CHARGE BATTERIES

Instructor PC

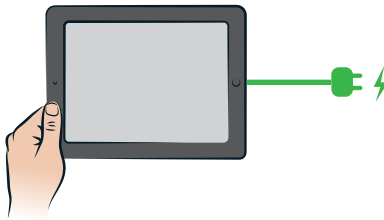

Patient Monitor

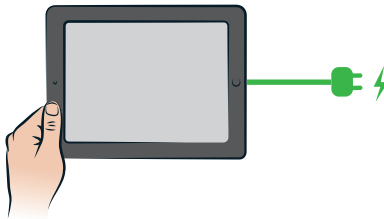

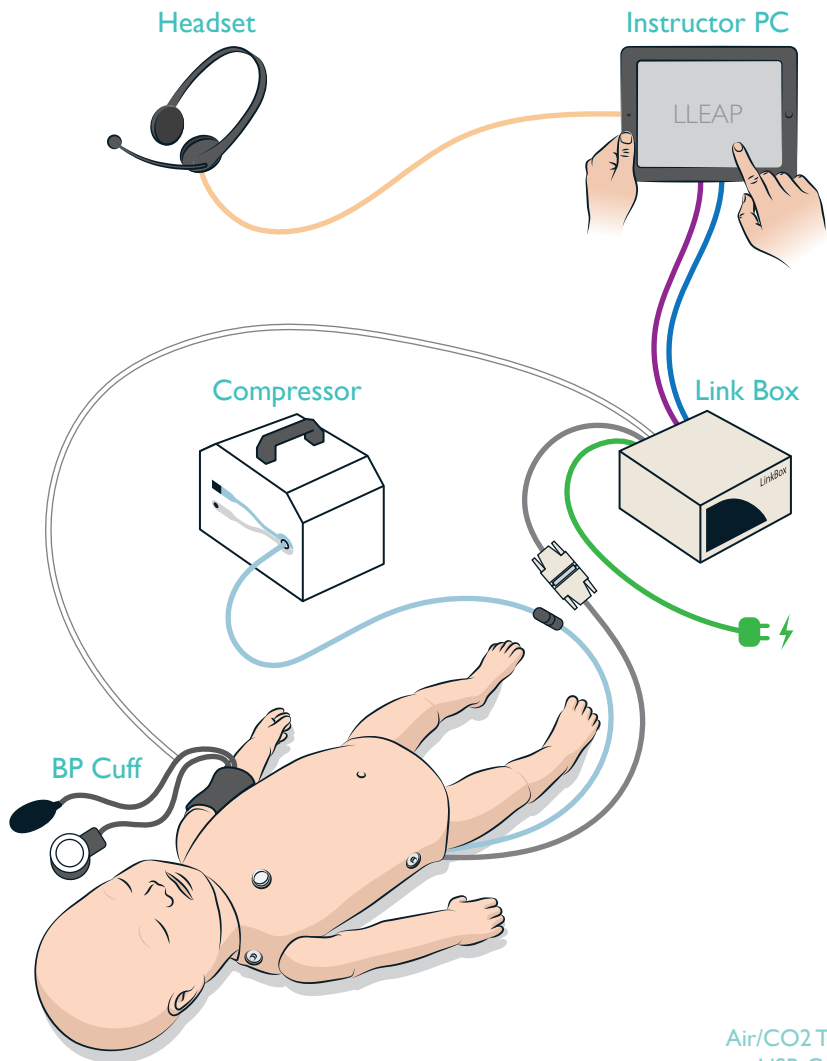

- Air/CO2 Tube —
- USB Cable —
- Simulator Cable —
- PC Cable —
- Audio Cable —
- BP Cuff Cable —
- Power Cable —

2B

SETUP WITH PATIENT MONITOR

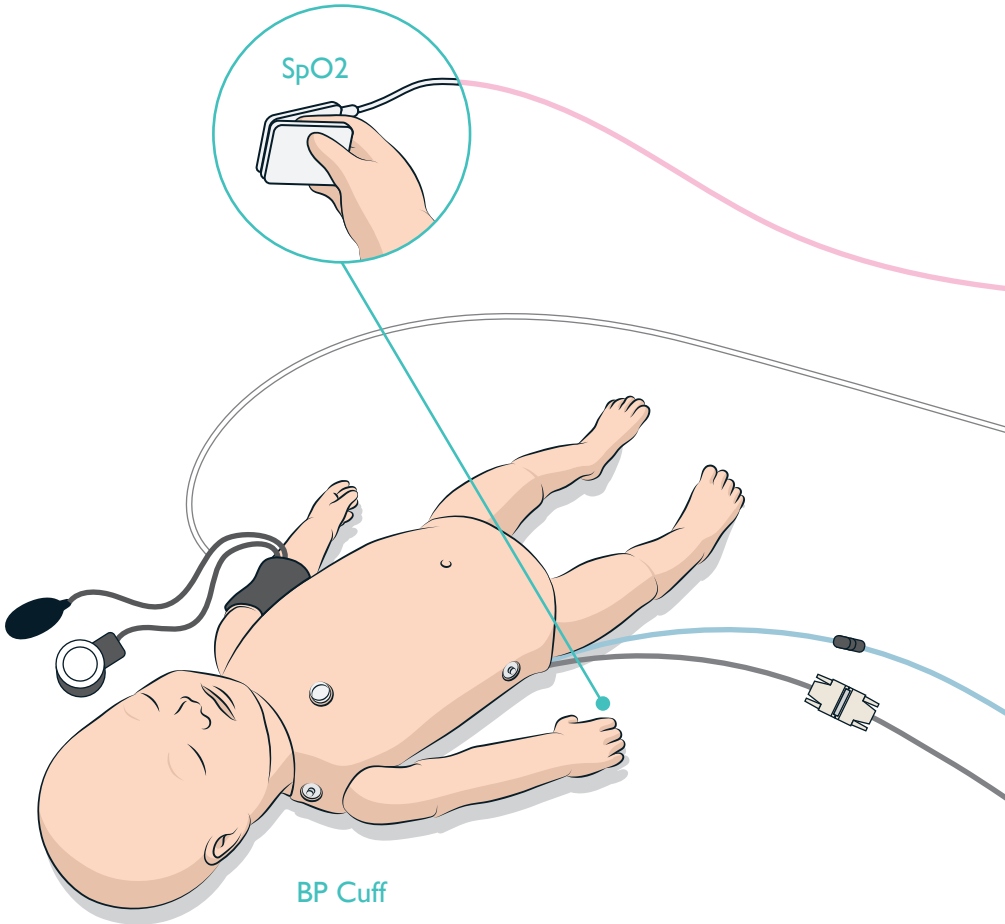

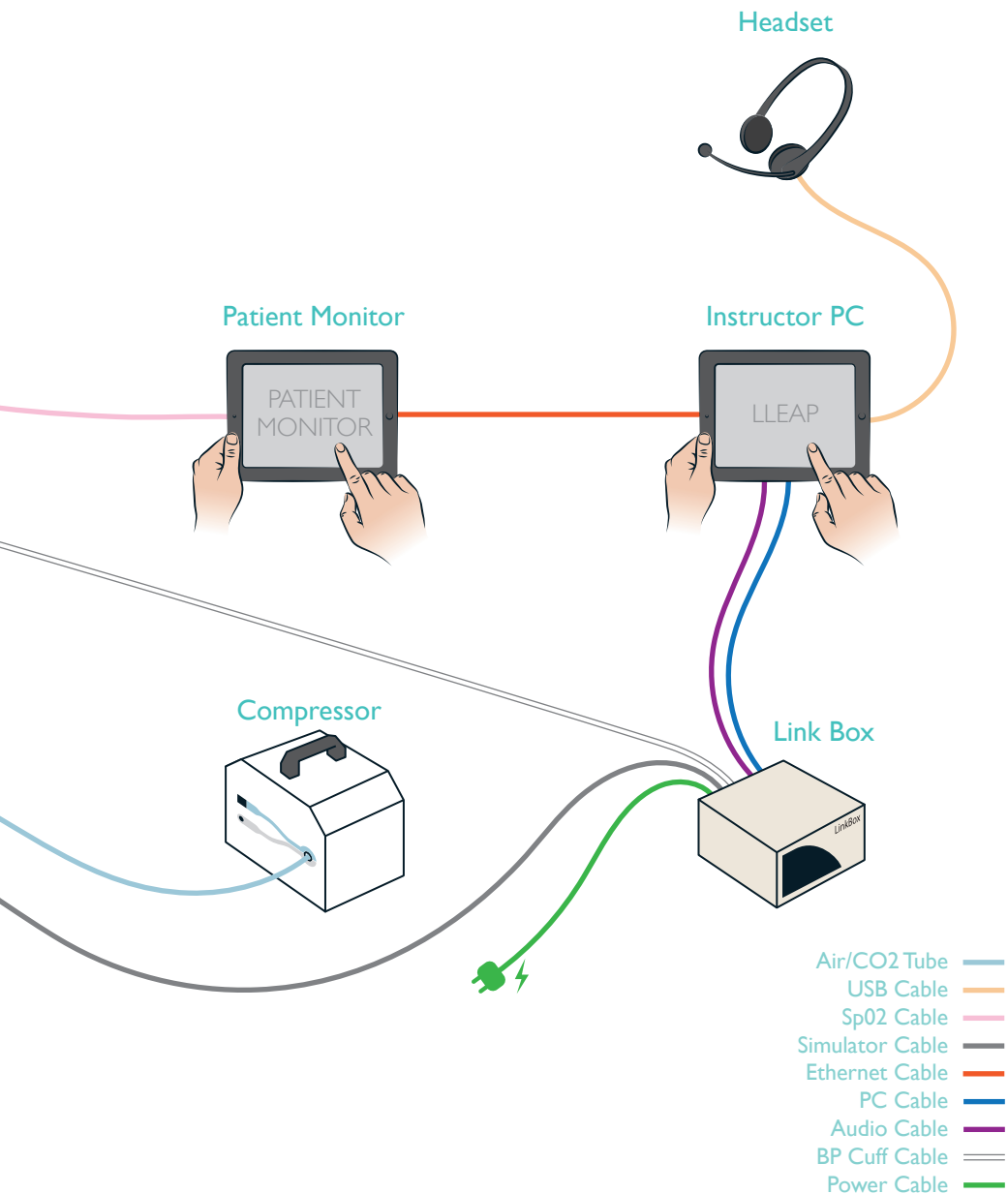

© 2014 Laerdal Medical AS. All rights reserved.
Printed in Norway.

20-07990 Rev B

www.laerdal.com



Laerdal
helping save lives